

SOUTH ELEVATION

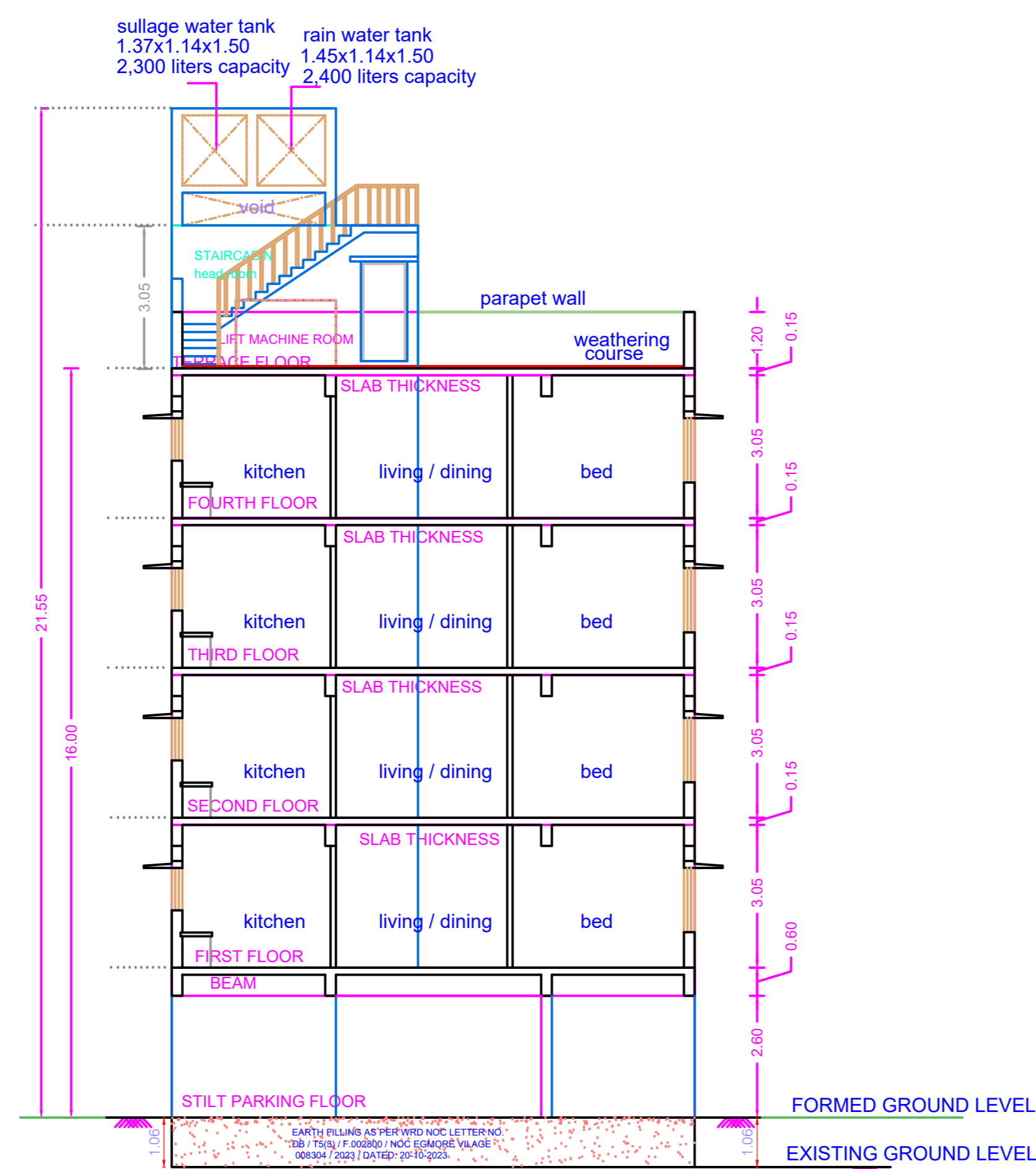

SECTION-AA

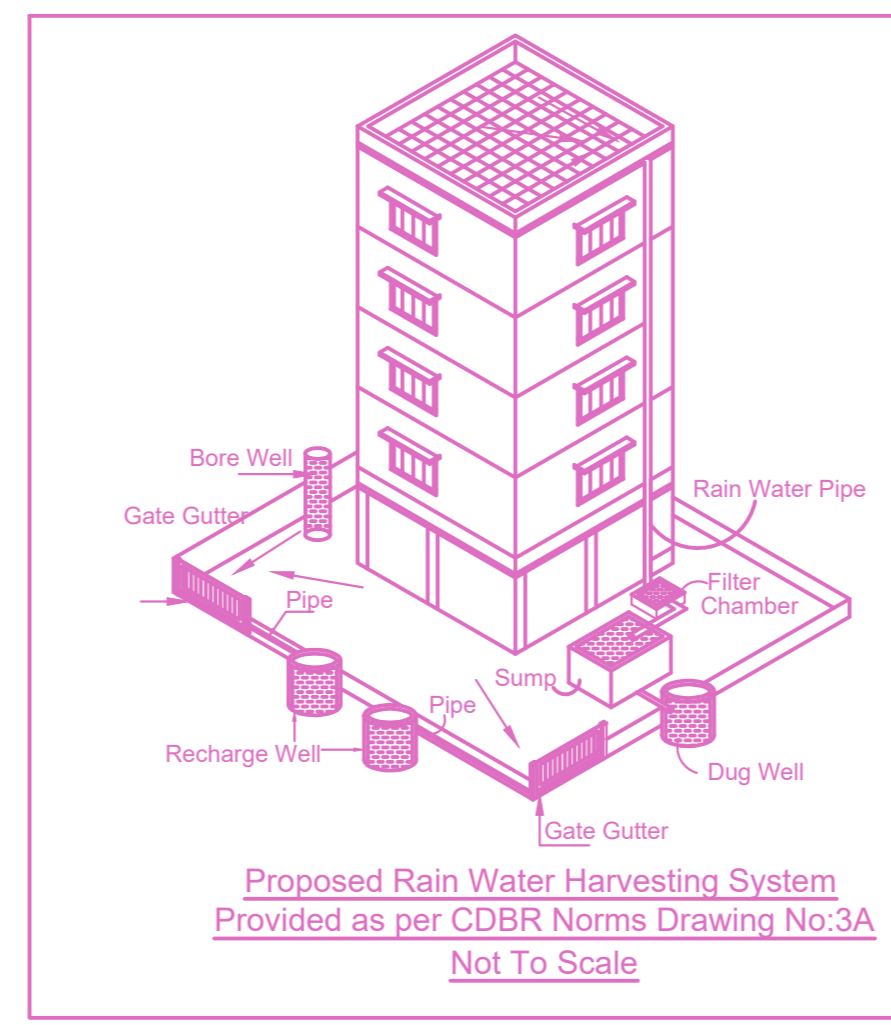

Proposed Rain Water Harvesting System Provided as per CDBR Norms Drawing No:3A Not To Scale

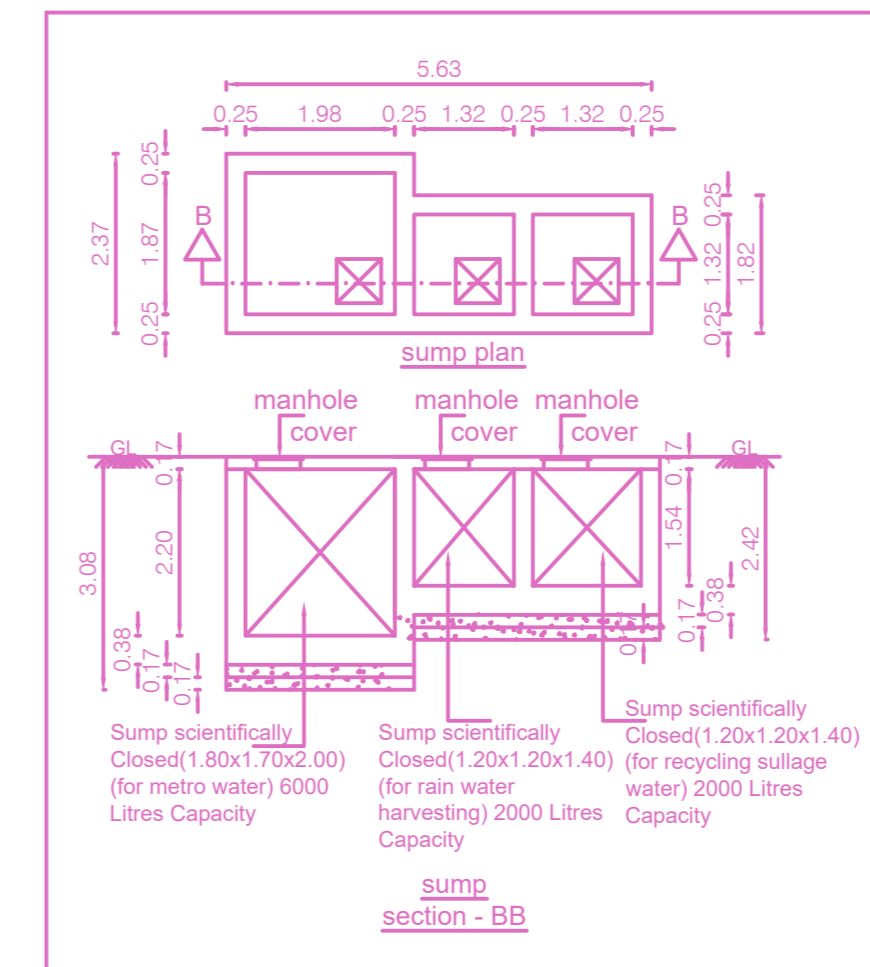

Sump section-BB

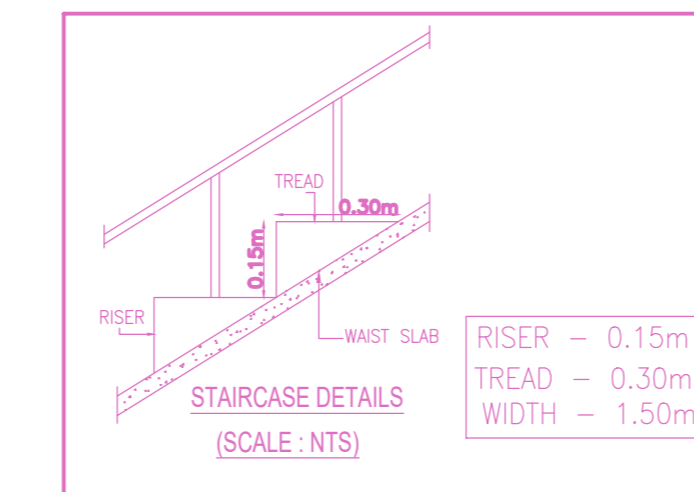

STAIRCASE DETAILS (SCALE: MTS)

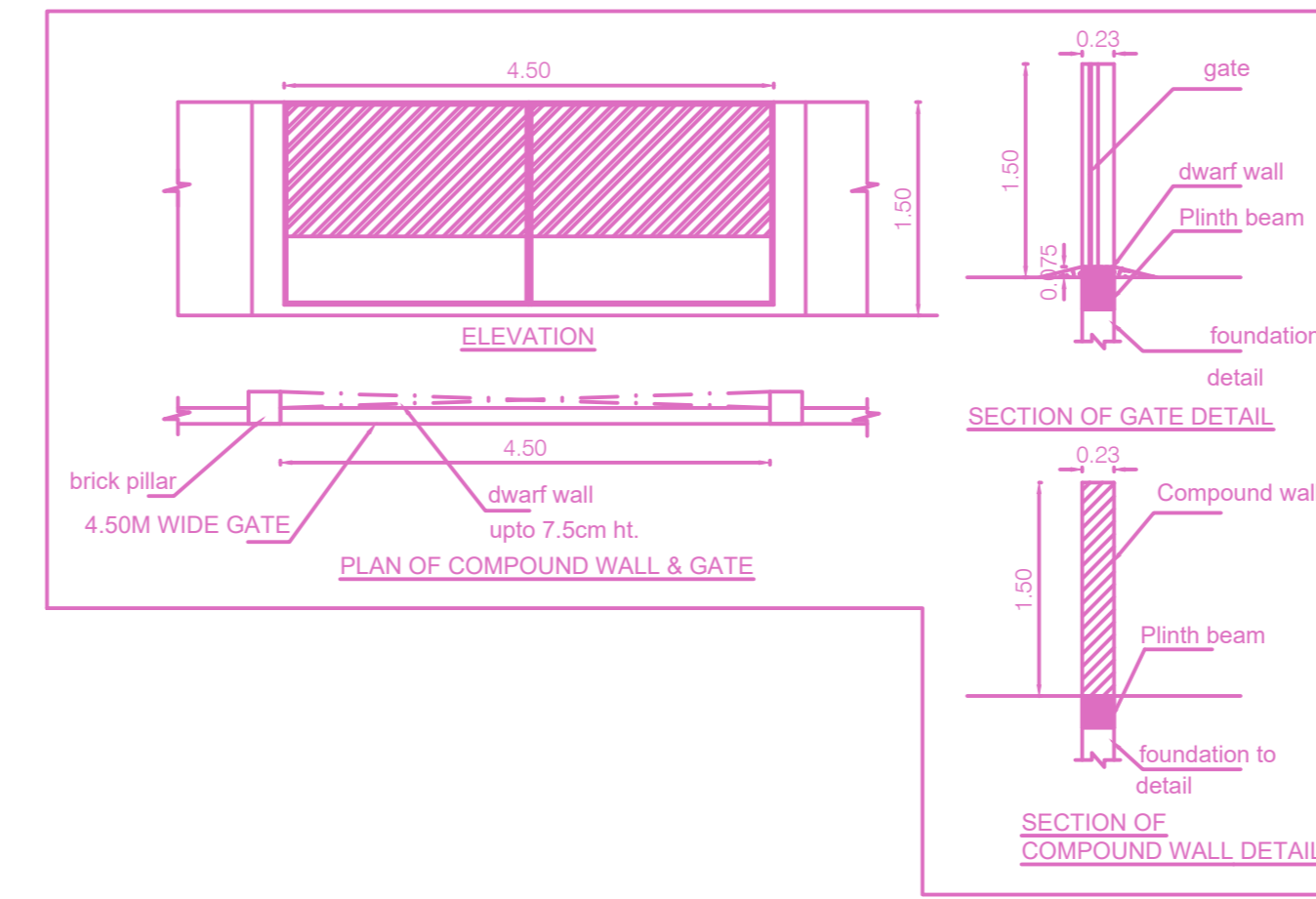

PLAN OF COMPOUND WALL & GATE

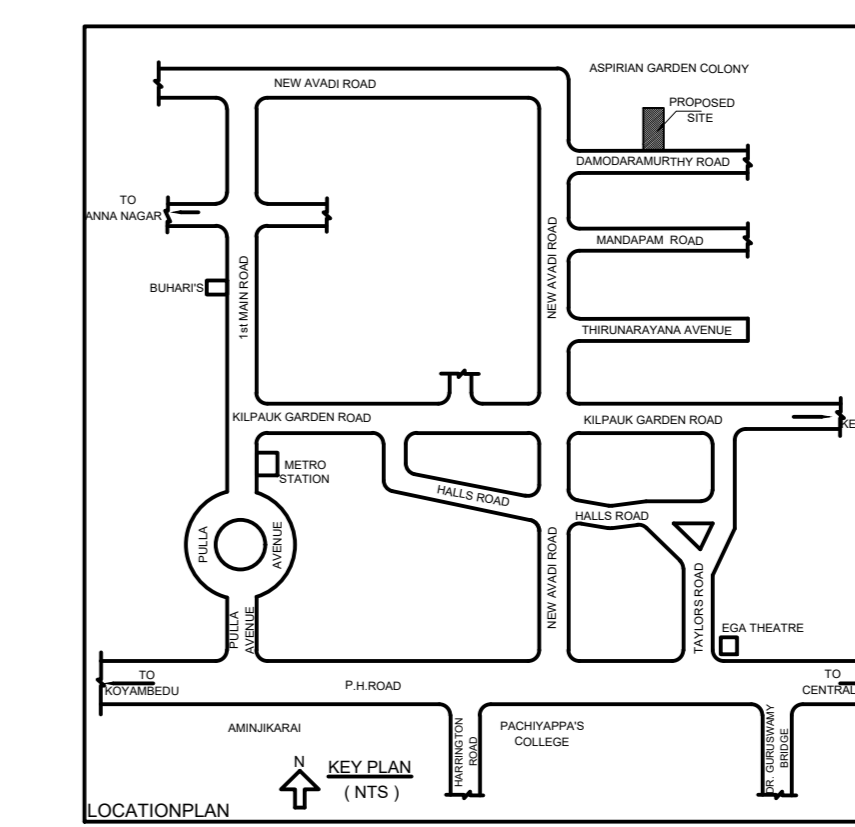

PLAN SHOWING THE PROPOSED CONSTRUCTION OF STILT FLOOR [ PARKING ] + 4 FLOORS RESIDENTIAL BUILDING WITH 8 DWELLING UNITS AVAILING PREMIUM FSI [ HEIGHT - 16.00 M ] AT PLOT NO : 13 & 14, DOOR NO : 8 / 17, DHAMODARAMURTHY ROAD, KILPAUK, CHENNAI - 600 010. COMPRISED IN OLD S.NO : 71, NEW R.S.NO : 71 PART, T.S.NO : 71 / 35, BLOCK - 6 OF EGMORE VILLAGE, WITH IN THE LIMIT OF GREATER CHENNAI CORPORATION.

A) AREA STATEMENT	SQ.M.
AREA AS PER PATTA	568.00
AREA AS PER DOCUMENT	568.19
AREA CONSIDERED FOR FSI	568.00
STREET ALIGNMENT/ ROAD WIDENING/LINK ROAD	0.00
OSR AREA	0.00
TOTAL FSI AREA	1155.20
FSI FACTOR	2.034
COVERAGE AREA (PERCENTAGE %)	NA

A) PARKING STATEMENT		
VEHICLE	REQUIRED	PROVIDED
LORRY	-	0
CAR	9	9
TWO WHEELER	0	0
CYCLE	-	0

BUILDING WISE FSI STATEMENT						
BUILDING	NO OF SAME BUILDINGS	COMM	RESI.	IND.	INST.	TOTAL FSI AREA
DAMODHARAMURTHY...	1	0.00	1155.20	0.00	0.00	1155.20
<b>Total</b>		0.00	1155.20	0.00	0.00	1155.20

FLOOR WISE FSI STATEMENT: DAMODHARAMURTHY STREET...						
FLOORS	COMM.	RESI.	IND.	INST.	DU	TOTAL FSI AREA
STILT PARKING FLOOR	0.00	0.00	0.00	0.00	0	0.00
FIRST FLOOR	0.00	288.80	0.00	0.00	2	288.80
SECOND FLOOR	0.00	288.80	0.00	0.00	2	288.80
THIRD FLOOR	0.00	288.80	0.00	0.00	2	288.80
FOURTH FLOOR	0.00	288.80	0.00	0.00	2	288.80
Terrace	0.00	0.00	0.00	0.00	0	0.00
<b>Total</b>	0.00	1155.20	0.00	0.00	8	1155.20

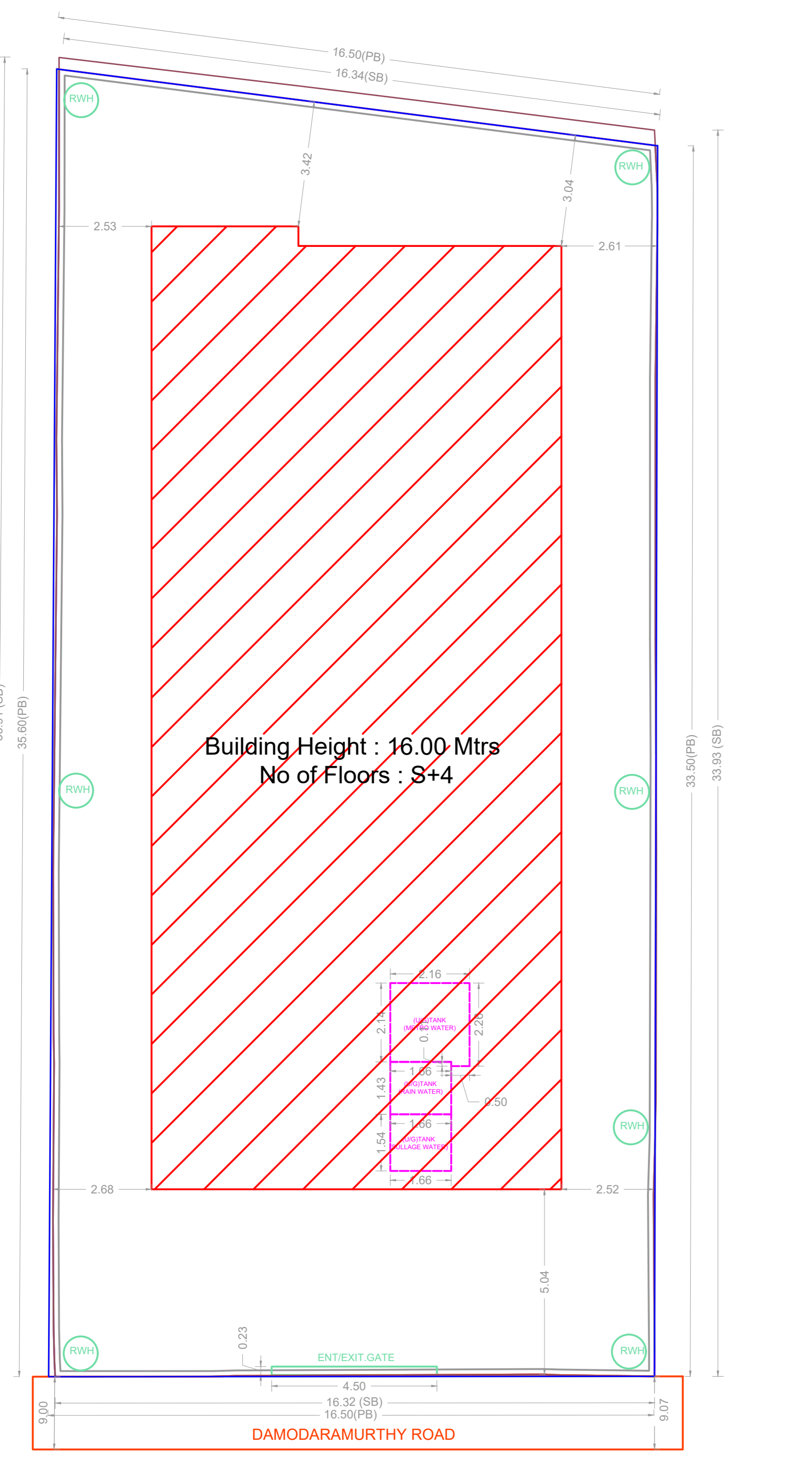

SITE PLAN

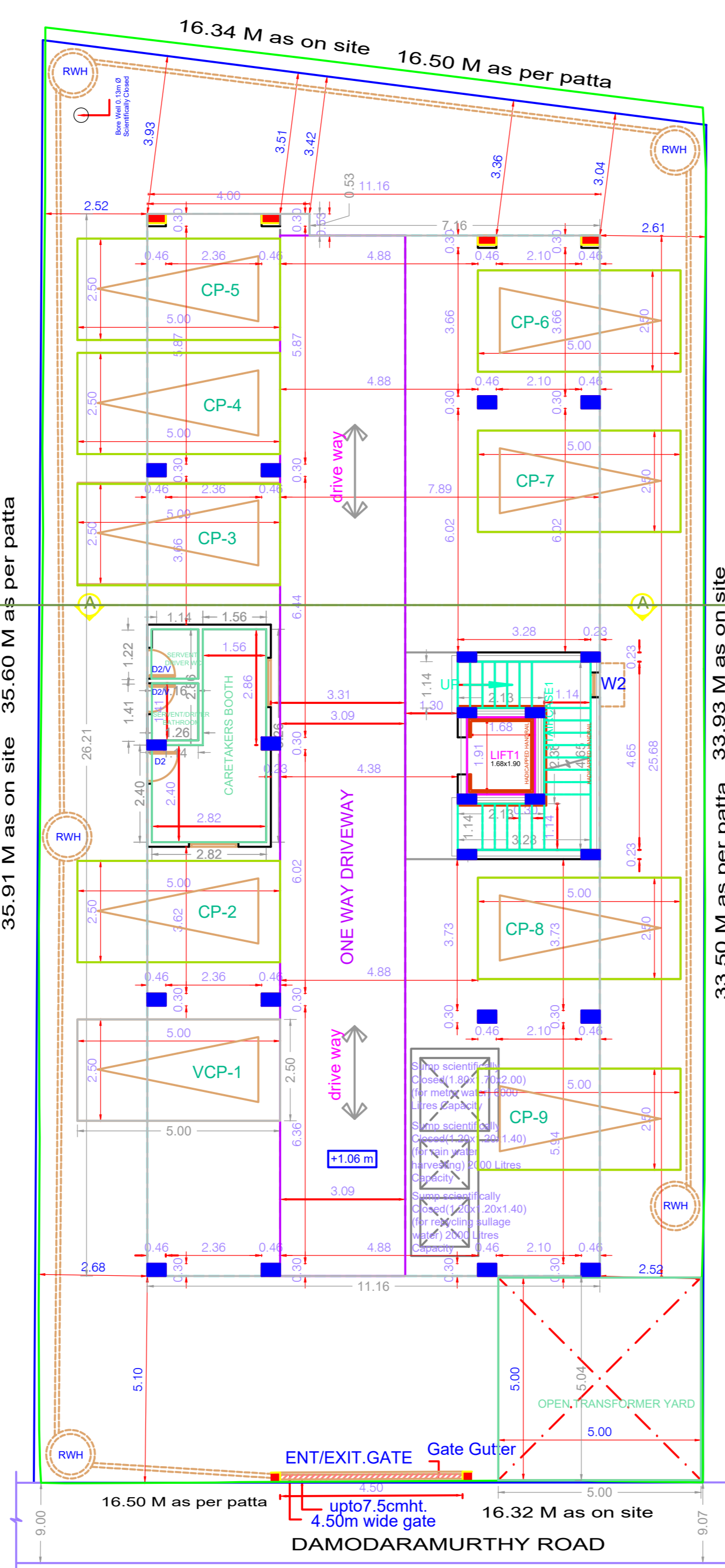

STILT PARKING FLOOR PLAN

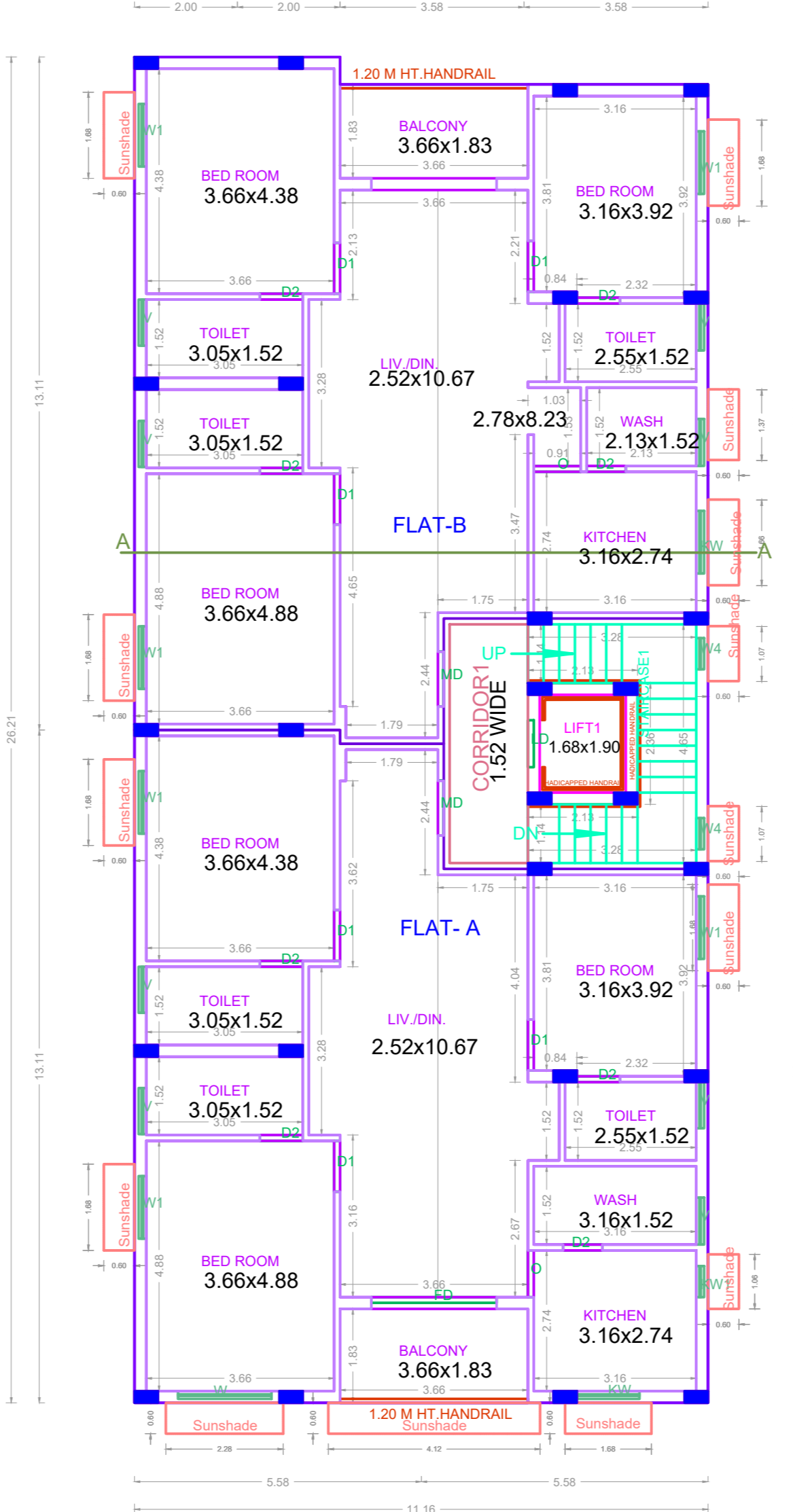

TYPICAL - 1, 2, 3, 4 FLOOR PLAN

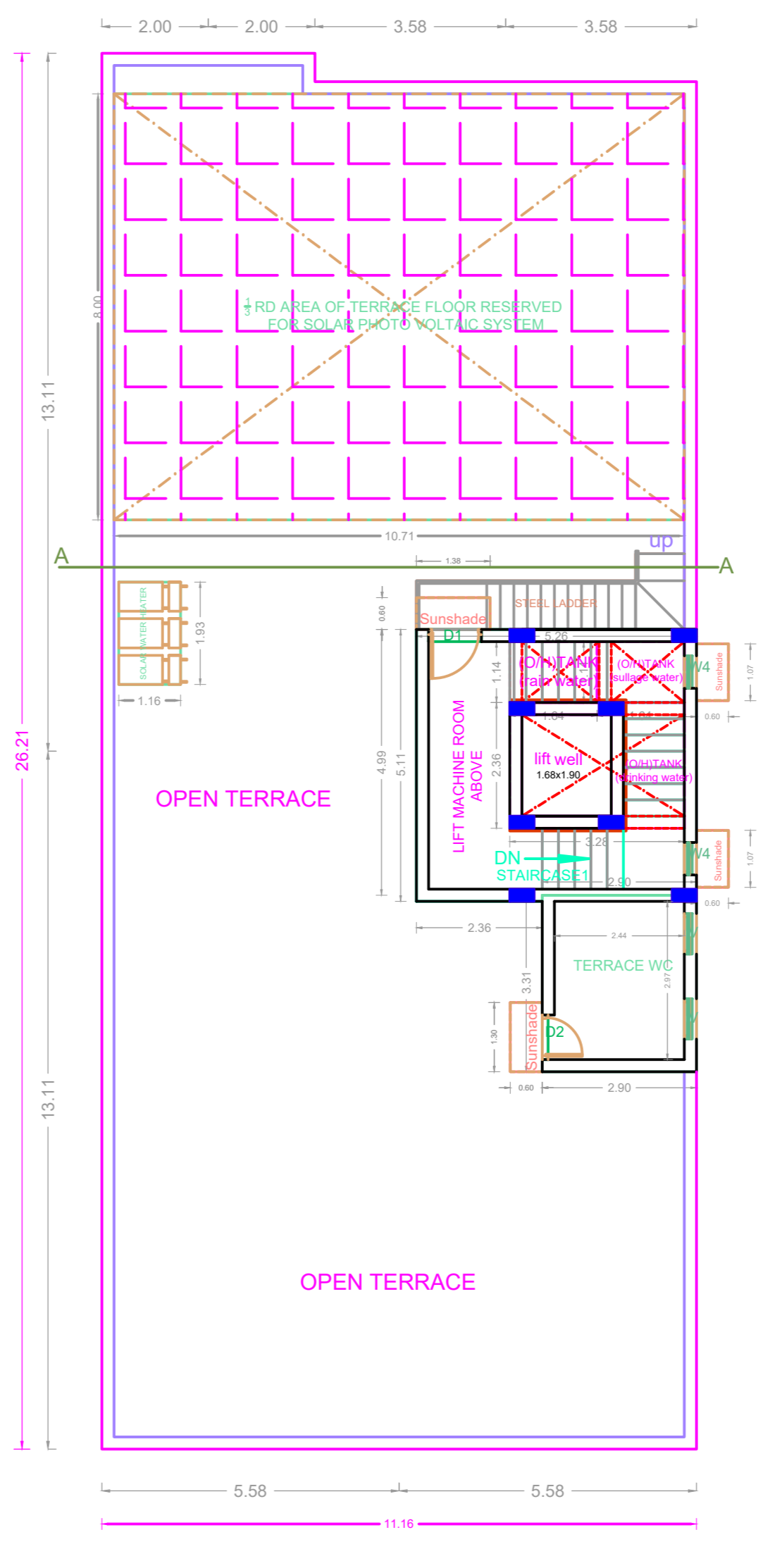

TERRACE FLOOR PLAN

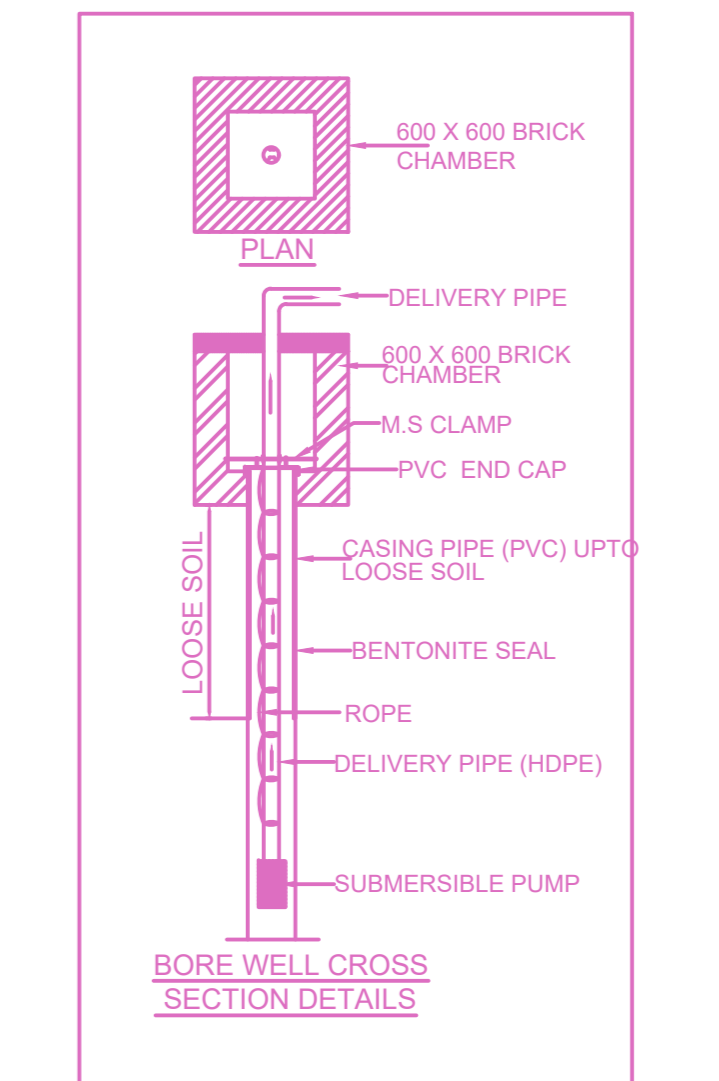

BORE WELL CROSS SECTION DETAILS

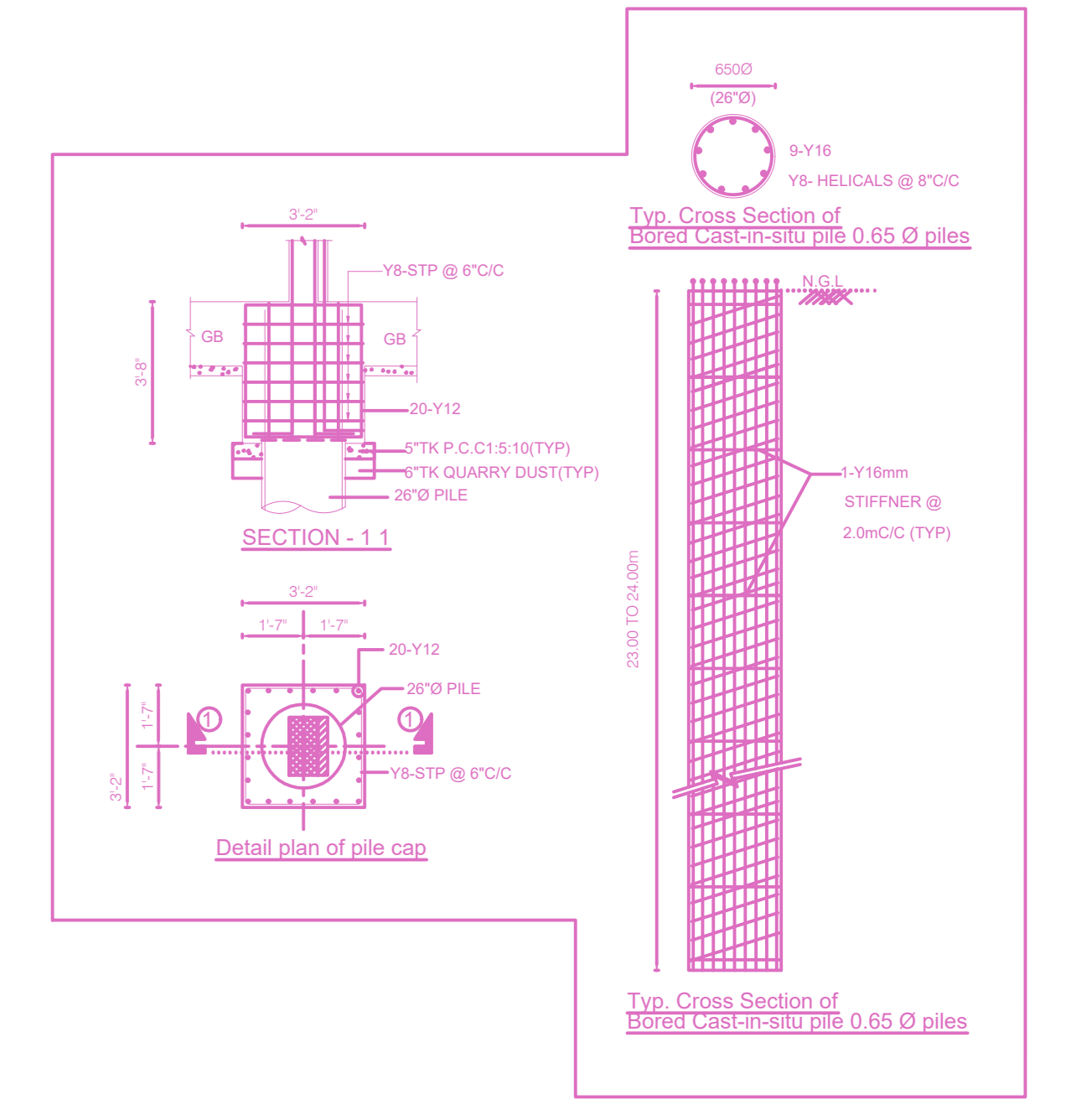

Typ. Cross Section of Bore Well (Casing Pipe 0.65 Ø pipes)

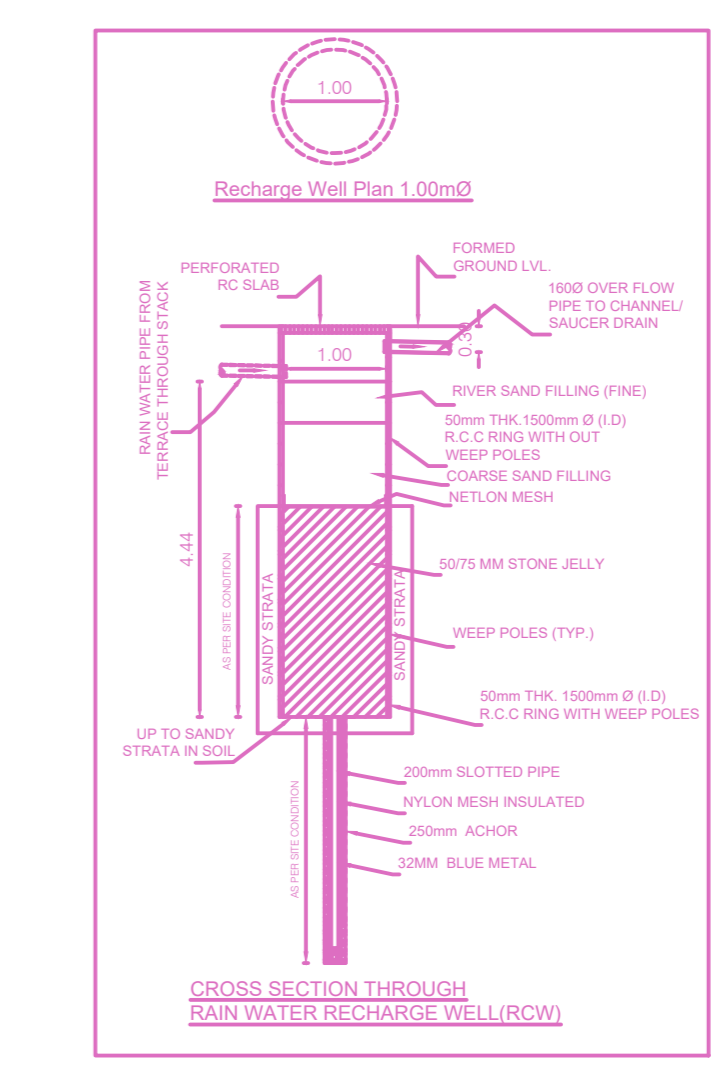

SOLAR HOT WATER SYSTEM DETAIL

APPROVAL CONDITION

SCALE 1:100

CHENNAI METROPOLITAN DEVELOPMENT AUTHORITY  
APPROVED

SUBJECT TO THE CONDITIONS MENTIONED IN THIS OFFICE

For (Deputy Planner / Chief Planner / Member-Secretary)  
High Rise Building / Non High Rise Building  
This Approval is valid only after building Permit is issued by the concerned Local Body.

