

TOTAL EXTENT : 8050 M²
 ROAD AREA : 3074 M²
 NO. OF PLOTS : 28 NOS.

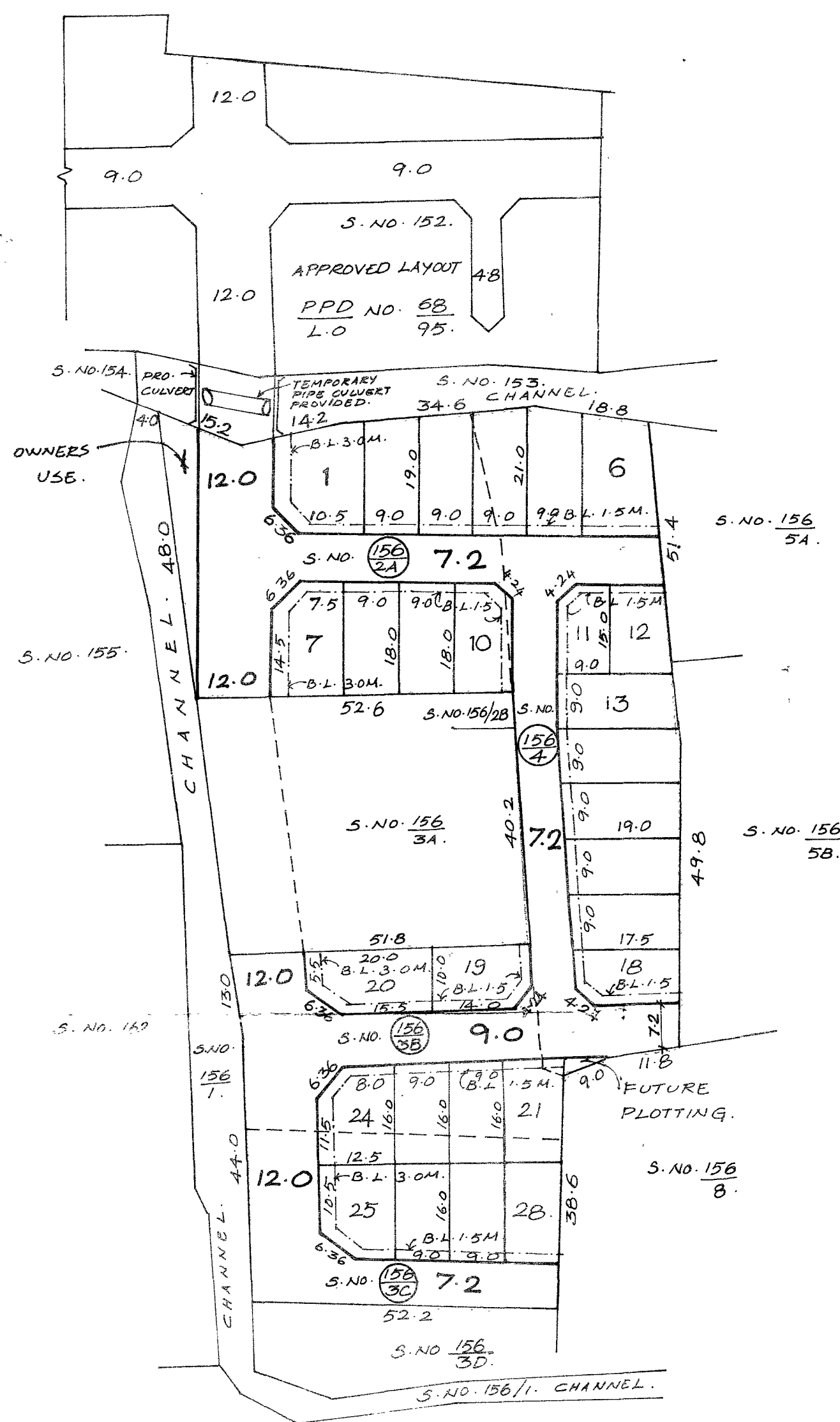

NOTE :

1. SPLAY - 3.0 M X 3.0 M, 4.5 M X 4.5 M.
2. MEASUREMENTS ARE INDICATED EXCLUDING SPLAY DIMENSIONS.
3. ROAD AREA WAS ALREADY HANDED OVER TO THE LOCAL BODY.
 VIDE GIFT DEED DOCUMENT NO: 11251/08. DATED: 30.10.08.

CONDITION :

THE FOLLOWING CONDITIONS OF PWD STIPULATED IN CHIEF ENGINEER, P.W.D. W.R.O. CHENNAI REGION, CHEPAUK, CHENNAI - 5. LETTER NO. T5 (3) / 844 / 2008. Dt. 13.3.2008. ARE TO BE COMPLIED BY THE APPLICANT WHILE FORMATION OF THE LAYOUT.

1. THE PROCESS OF EARTH FILLING AND COMPACTION SHOULD BE DONE ONLY AFTER THE ERECTION OF FOUNDATION FOOTINGS.
2. THE PROCESS OF FILLING AND COMPACTION SHOULD BE DONE IN LAYERS OF NOT MORE THAN 0.30M DEPTH TO ACHIEVE THE REQUIRED DEGREE OF COMPACTION.
3. THE PROMOTER SHALL PROVIDE ADEQUATE DEWATERING ARRANGEMENTS TO BAILOUT THE WATER WITHIN THE PREMISES AND NECESSARY DRAINAGE FACILITIES MUST BE SUITABLY PROVIDED.
4. THE PROMOTER SHOULD PROVIDE NECESSARY RAINWATER HARVESTING ARRANGEMENTS IN THE PROPOSED SITE.
5. THE WIDTH OF THE FIELD CHANNEL EARMARKED IN THE SKETCH SHOULD BE MAINTAINED WITHOUT ENCRUCHING AS PER REVENUE RECORDS.
6. THERE SHOULD NOT BE ANY HINDRANCE TO THE FREE FLOW OF WATER THROUGH THE EXISTING CHANNEL TO THE DOWNSITE COMMAND AREA (I.E.) UPTO TANDURAI TANK. IF ANY OBSTRUCTIONS BLOCKAGES ARE MADE BY THE PROMOTER IN THE CHANNEL WILL BE EVICTED BY THIS DEPARTMENT WILL WITHDRAW THE PERMISSION IMMEDIATE WITHOUT ANY PRIOR NOTICE.
7. A MINIMUM OFFSET SHOULD BE PROVIDED FROM THE EDGE OF THE CHANNEL BOUNDARY ABUTING THE ENTIRE NORTHERN BOUNDARY OF THE SITE TO PROTECT THE WATER FRONT.
8. THE IRRIGATION CHANNEL SHOULD BE WELL PRESERVED BY THE PROMOTER BY MEANS OF PERIODICAL DESILTING WORKS. WITHIN HIS BOUNDARY TO FACILITATE IRRIGATION.
9. THE PROMOTER SHOULD NOT CARRYOUT ANY OTHER CROSS MASONRY STRUCTURES ACROSS THE CHANNEL WITHOUT PRIOR PERMISSION FROM PWD.
10. THE PROMOTER SHOULD STRICTLY ADHERE TO MAINTAIN THE HYDRAULIC PARTICULARS OF THE CHANNEL.
11. THE PROPOSED CULVERT SHALL BE MADE OF RCC BOX TYPE OF SIZE 12.0 M X 4.0 M ACROSS THE FIELD CHANNEL FOR CROSSING.
12. THE PROMOTER SHOULD CONSTRUCT THE CULVERT AT HIS OWN COST.
13. THE SILL LEVEL OF THE CULVERT SHOULD BE MAINTAINED AS (+) 29.330 m WITH REFERENCE TO M.S.L.
14. THE PROMOTER IS SOLELY RESPONSIBLE FOR THE STRUCTURAL SAFETY AND DESIGN OF THE CULVERT.
15. THE PROPOSED CULVERT SHALL BE CONSTRUCTED IN SURVEY NO. 153 FOR PROVIDING ACCESS TO THE LAND IN SURVEY NO. 156. AS EARMARKED IN THE TOPO SKETCH.
16. THE DESIGN AND DRAWINGS OF THE PROPOSED RCC CULVERT SHOULD BE GOT APPROVED BY THE EXECUTIVE ENGINEER, PWD WRO, KOSASTHALAIYAR BASIN DIVISION, TIRUVALLUR AND SHOULD BE GOT EXECUTED AMIDST THE PRESENCE OF PWD OFFICIALS ONLY.
17. THE PROMOTER SHOULD NOT PROVIDE ANY OTHER CROSS MASONRY STRUCTURES WITHOUT PRIOR APPROVAL FROM PWD.
18. THE PWD OFFICIALS SHOULD BE ALLOWED TO INSPECT THE SITE AT ANY TIME DURING EXECUTION.
19. THE PROMOTER SHOULD ABIDE BY THE RULES AND REGULATIONS OF PWD FROM TIME TO TIME.
 FAILING TO COMPLY ANY OF THE ABOVE CONDITIONS, THE DEPARTMENT RESERVE THE RIGHT TO WITHDRAW THE PERMISSION GRANTED.

LEGEND :

- SITE BOUNDARY
- PROPOSED ROAD.
- EXISTING ROAD.
- CHANNEL.

THIRUNINRAVUR TOWN PANCHAYAT.
 LAYOUT OF HOUSE SITES IN S. NO. 156/2A, 2B, 2C & 4 OF
 THIRUNINRAVUR VILLAGE.

SCALE - 1:800. (ALL MEASUREMENTS ARE IN METRE.)

P.P.D NO. 4
 L.O 2009.
 APPROVED I.C
 VIDE LETTER NO: L1/19354/08.
 DATED: 31/01/2009.
 42-09
 FOR MEMBER SECRETARY
 CHENNAI METROPOLITAN
 DEVELOPMENT AUTHORITY.

