

TOTAL EXTENT (0.34 Ac) : 1400 M<sup>2</sup>  
 ROAD AREA : 122 M<sup>2</sup>  
 No. OF PLOTS : 4 Nos.

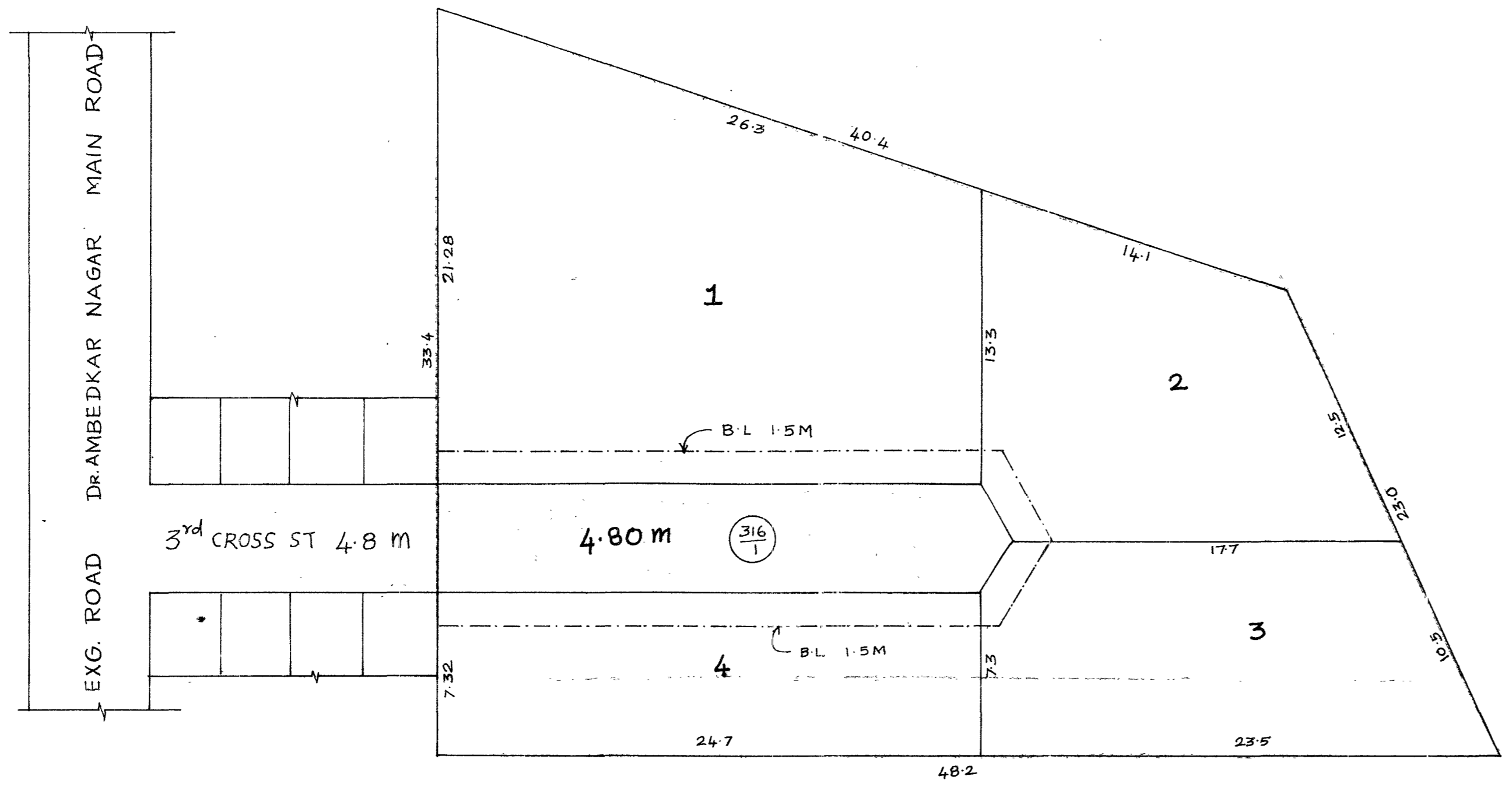

**LEGEND:-**  
 SITE BOUNDARY  
 PROPOSED ROAD  
 EXISTING ROAD

P.P.D NO. 6  
 L.O APPROVED 2009  
 I.C  
 VIDE LETTER No : LI / 9972 / 08  
 DATED : 13/02/09

**OFFICE COPY**  
 FOR MEMBER-SECRETARY  
 CHENNAI METROPOLITAN  
 DEVELOPMENT AUTHORITY



**PALLAVARAM MUNICIPALITY**

PLAN SHOWING THE PROPOSED SUB-DIVISION OF HOUSE SITES IN S.NO: 316/1 OF ZAMIN PALLAVARAM VILLAGE.

SCALE : 1:200 ( ALL MEASUREMENTS ARE. IN METRE ONLY.)