

TOTAL EXTENT	: 44400 M ²
ROAD AREA	: 12523 M ²
PARK AREA	: 3219 M ²
PUBLIC PURPOSE PLOTS (I TO XV)	: 3231 M ²
TOTAL No. OF PLOTS	: 200 Nos.
REGULAR PLOTS (1 TO 126)	: 126 Nos.
E.W.S PLOTS (3383 M ²) (127 TO 200)	: 74 Nos.

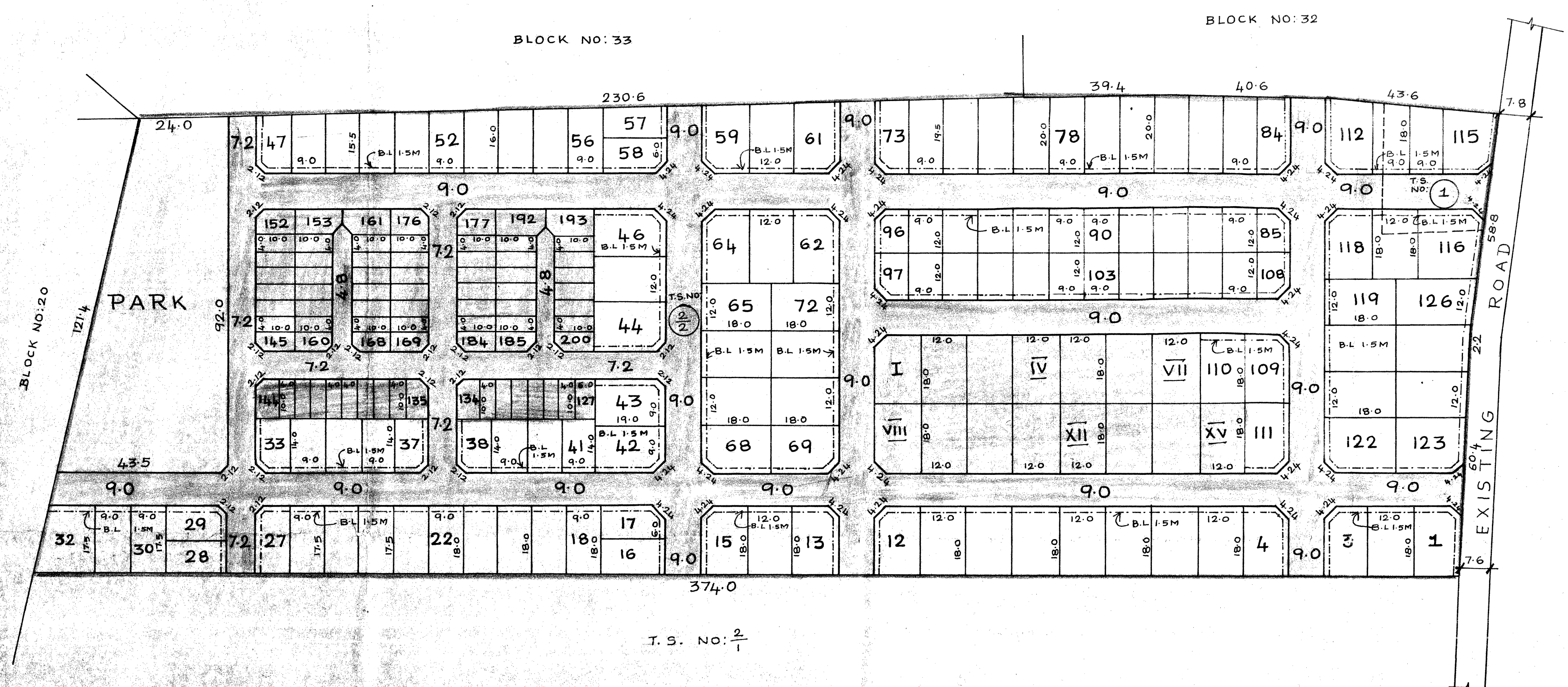

NOTE:-

1. SPLAY 1.5 M X 1.5 M, 3.0 M X 3.0 M
2. MEASUREMENTS INDICATED ARE EXCLUDING THE SPLAY DIMENSIONS.
3. ROAD AREA WERE ALREADY HANDED OVER TO THE LOCAL BODY
PARK AREA VIDE GIFT DEED NO: 5354/2009 DT. 21.8.2009.

CONDITIONS:-

(i) THE AREA EARMARKED FOR PUBLIC PURPOSE PLOTS I TO XV (VIZ. POST AND TELEGRAPH OFFICE, POLICE STATION ETC) WOULD REMAIN RESERVED FOR A SPECIFIC PERIOD OF ONE YEAR FROM THE DATE OF APPROVAL TO ENABLE THE GOVERNMENT DEPT. CONCERNED TO NEGOTIATE WITH THE OWNER AND ACQUIRE THE RESERVED LAND IF REQUIRED FOR THEM. THE COST OF THE PLOT SHOULD NOT BE MORE THAN GUIDELINE VALUE. IF THE PROMOTER ADDS PROPORTIONATE DEVELOPMENT COST ON THE PRICE OF THE PUBLIC PURPOSE PLOT, THE SAME SHOULD BE APPROVED BY CMDA. AFTER THE SAID PERIOD OF ONE YEAR AND IF NONE OF THE AGENCIES PURCHASE THE RESERVED LAND FULL/PART, THE LAYOUT OWNER/DEVELOPER IS FREE TO DISPOSE OF THE SITE RESERVED FOR PUBLIC PURPOSE TO ANY BODY FOR RESIDENTIAL USE ONLY.

(ii) DR. RULE No: 29(ii)
THE COST OF LAYING/IMPROVEMENT TO THE SYSTEMS IN RESPECT OF ROAD, WATER SUPPLY, SEWERAGE, DRAINAGE OR ELECTRIC POWER SUPPLY THAT MAY BE REQUIRED AS ASSESSED BY THE COMPETENT AUTHORITY, SHALL BE BORNE BY THE APPLICANT.

LEGEND:-

- SITE BOUNDARY
- PROPOSED ROAD
- EXISTING ROAD
- PARK
- PUBLIC PURPOSE PLOTS
- E.W.S

P.P.D No. 40
L.O APPROVED 2009
VIDE LETTER No: LI/13289/09
DATED : 23/09/2009
FOR OFFICE COPY
FOR MEMBER SECRETARY
CHENNAI METROPOLITAN
DEVELOPMENT AUTHORITY

MADHAVARAM MUNICIPALITY

LAYOUT OF HOUSE SITES IN S.No: 205/2 (AS PER DOCUMENT) AND T.S.No: 1, 2/2 (AS PER TOWN SURVEY FIELD REGISTER EXTRACT) OF MADHAVARAM VILLAGE.

SCALE: 1:800 (ALL MEASUREMENTS ARE IN METRE ONLY.)

