

SITE EXTENT (AS PER PATTA) - 3350 SQ.M  
ROAD AREA - 867 SQ.M  
TOTAL NO. OF PLOTS - 8 Nos.

**NOTE:**

1. SPLAY - 1.5M x 1.5M
2. MEASUREMENTS ARE INDICATED EXCLUDING SPLAY DIMENSIONS
3.  ROAD AREA WAS HANDED OVER TO THE LOCAL BODY

VIDE GIFT DEED DOCUMENT NO.16003/2019, DATED:14.11.2019, @ SRO AVADI.

**CONDITION :**

TNCDBR RULE No: 47 (11) :

THE COST OF LAYING IMPROVEMENTS TO THE SYSTEMS IN RESPECT OF ROAD, WATER SUPPLY, SEWERAGE, DRAINAGE OR ELECTRIC POWER SUPPLY THAT MAY BE REQUIRED AS ASSESSED BY THE CONCERNED AUTHORITY, NAMELY, THE LOCAL BODY AND TAMIL NADU ELECTRICITY BOARD, SHALL BE BORNE BY THE APPLICANT.

**LEGEND**

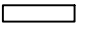
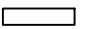
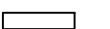
-  SITE BOUNDARY
-  ROADS GIFTED TO LOCAL BODY
-  EXISTING ROAD

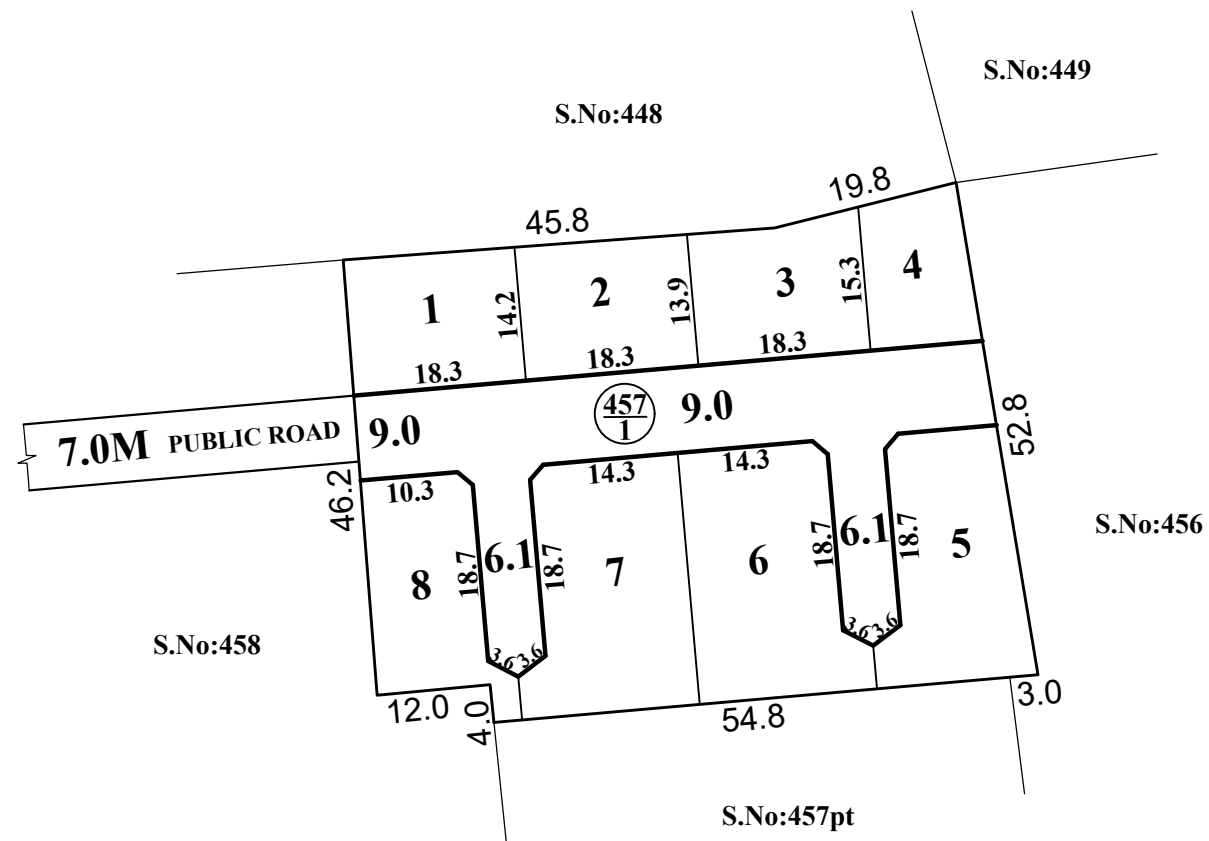

This Planning Permission Issued under New Rule TNCDBR.2019 is subject to final outcome of the W.P(MD) No.8948 of 2019 and WMP (MD) Nos. 6912 & 6913 of 2019.

**CONDITION:**

THE SUB-DIVISION APPROVED IS VALID SUBJECT TO OBTAINING SANCTION FROM THE LOCAL BODY CONCERNED.

**P.P.D** NO: 128  
**L.O** 2019

**APPROVED**

**VIDE LETTER NO** : L1 / 15314 / 2019  
**DATE** : 22 / 11 / 2019

**OFFICE COPY**

FOR CHIEF PLANNER (MSB/LAYOUT)  
CHENNAI METROPOLITAN  
DEVELOPMENT AUTHORITY

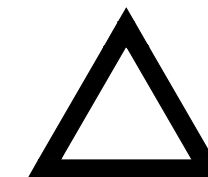

**POONAMALLEE PANCHAYAT UNION**

**SUB-DIVISION OF HOUSE SITES IN S.No: 457/1 OF THIRUNINDRAVUR 'B' VILLAGE.**

**SCALE : 1:800 (ALL MEASUREMENTS ARE IN METRE.)**