

**SITE EXTENT** (AS PER APPD. LAYOUT) = **2065 Sq.M**

**TOTAL NO. OF PLOTS** = **7 Nos.**

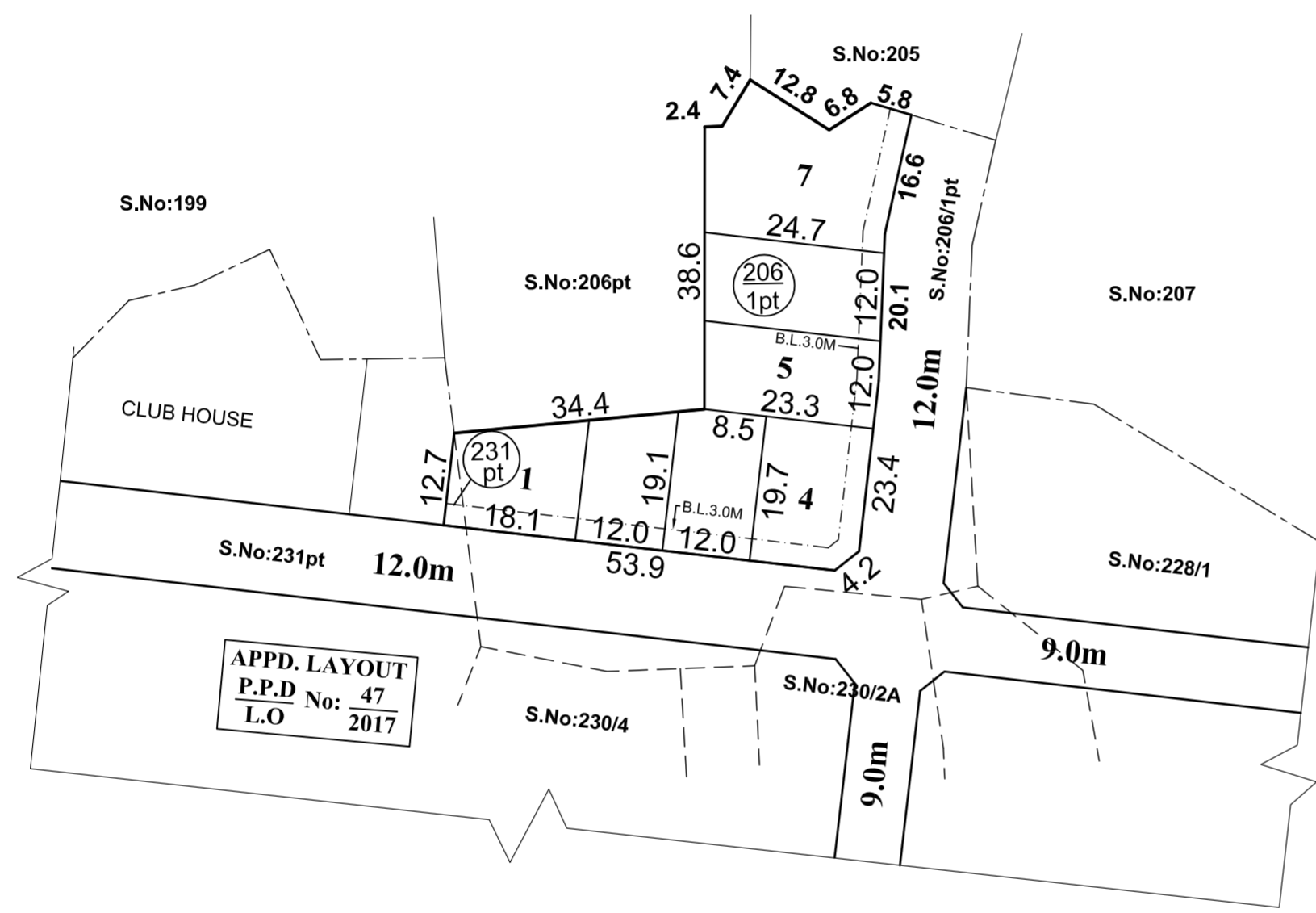

**NOTE:**

MEASUREMENTS ARE INDICATED EXCLUDING SPLAY DIMENSIONS

**CONDITIONS :**

DR RULE NO: 29 (11)

THE COST OF LAYING IMPROVEMENTS TO THE SYSTEMS INRESPECT OF ROAD, WATER SUPPLY, SEWERAGE, DRAINAGE OR ELECTRIC POWER SUPPLY THAT MAY BE REQUIRED AS ASSESSED BY THE COMPETENT AUTHORITY, SHALL BE BORNE BY THE APPLICANT.

**LEGEND:**

- SITE BOUNDARY
- EXISTING ROAD

**CONDITIONS:**  
THE SUB-DIVISION APPROVED IS VALID SUBJECT TO OBTAINING SANCTION FROM THE LOCAL BODY CONCERNED.

**P.P.D** NO : 26  
**L.O** 2019  
**APPROVED**  
VIDE LETTER NO : L1 / 19555 / 2018  
DATE : 21 / 02 / 2019

**OFFICE COPY**

FOR MEMBER SECRETARY  
CHENNAI METROPOLITAN  
DEVELOPMENT AUTHORITY

# ST. THOMASMOUNT PANCHAYAT UNION

SKETCH SHOWING THE SUB-DIVISION OF PUBLIC PURPOSE PLOT Nos: I & II LYING IN THE APPROVED LAYOUT P.P.D/L.O.No:47/2017 INTO RESIDENTIAL PLOTS IN S.Nos:206/1pt & 231pt OF VENGAIVASAL VILLAGE.

SCALE : 1:800 (ALL MEASUREMENTS ARE IN METRE.)

