

TOTAL EXTENT (LEAST EXTENT AS PER DOCUMENT) : 571 SQ.M  
PRIVATE PASSAGE AREA : 77 SQ.M  
NO.OF.PLOTS : 6 Nos.

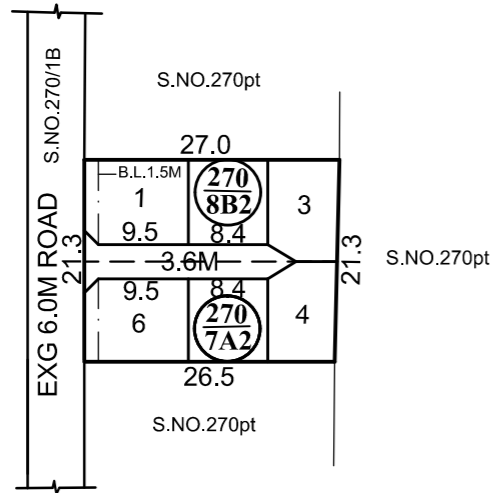



CONDITION:

DR RULE NO: 29 (11)

THE COST OF LAYING IMPROVEMENTS TO THE SYSTEMS IN RESPECT OF ROAD, WATER SUPPLY, SEWERAGE, DRAINAGE OR ELECTRIC POWER SUPPLY THAT MAY BE REQUIRED AS ASSESSED BY THE COMPETENT AUTHORITY, SHALL BE BORNE BY THE APPLICANT.

LEGEND :

-  SITE BOUNDARY
-  PASSAGE
-  EXISTING ROAD

CONDITION:-

THE SUB-DIVISION APPROVAL IS VALID SUBJECT TO OBTAINING SANCTION FROM THE LOCAL BODY CONCERNED

**P.P.D** NO **63**  
**L.O** **2019**

**APPROVED**

VIDE LETTER NO : L1 / 6438 / 2019

DATED : 28 / 05 / 2019

**OFFICE COPY**

FOR SENIOR PLANNER (MSB)  
CHENNAI METROPOLITAN  
DEVELOPMENT AUTHORITY.

**ANAKAPUTHUR MUNICIPALITY**

**SUB-DIVISION OF HOUSE SITES IN S.Nos: 270/7A2 AND S.No.270/8B2 OF ANAKAPUTHUR VILLAGE.**

SCALE - 1:800 (ALL MEASUREMENTS ARE IN METRE)

