

AREA STATEMENT

TOTAL EXTENT	: 4200.00 SQ M
ROAD AREA	: 1021.27 SQ M
PLOTTABLE AREA	: 3178.73 SQ M
SOLD OUT AREA	: 2096.35 SQ M
UNSOLD AREA	: 940.07 SQ M
10% OF THE TOTAL AREA OF UN SOLD PLOTS REQUIRED FOR OSR	: 94.00 SQ M
OSR PROVIDED	
PLOT NO'S (PLOT NO.35)	: 133.03 SQ M
UN SOLD AREA EXCLUDING OSR	: 807.04 SQ M
RESERVED FOR OSR (PLOT NO.35)	: 01 No
SOLD PLOTS	: 28 Nos
UN SOLD PLOTS	: 08 Nos
TOTAL NO. OF PLOTS	: 37 Nos

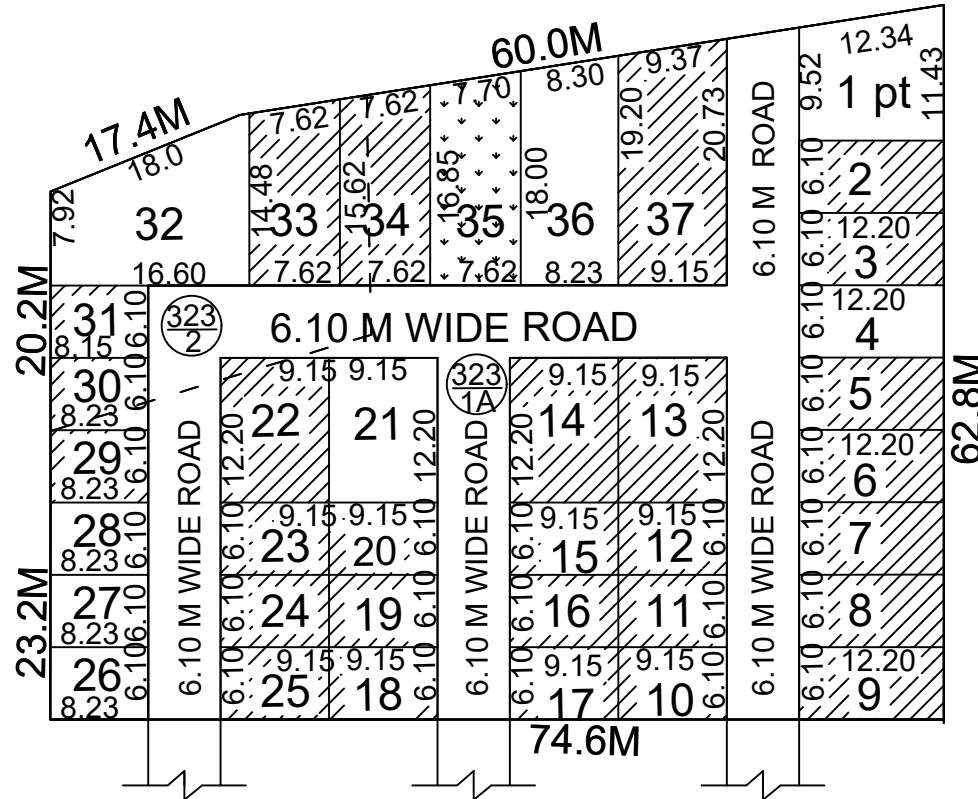

NOTE:

1. A SPLAY AT THE INTERSECTION OF TWO OR MORE STREETS / ROADS SHALL BE PROVIDED AS PER DR 29.
2. ROAD AREA OF 1417.42 SQ M AND PARK AREA OF 133.03 TO BE HANDED OVER TO THE COMMISSIONER, PUZHAL PANCHAYAT UNION VIDE GIFT DEED NO 060 / 2020, DATED 06.01.2020

CONDITIONS:

- 1) As per G.O.(ms).no.78 H & UD UD4 (3) department dt. 04.05.2017 and G.O. (Ms). No. 172 H & UD(UD4 (3) dept. dated. 13.10.2017 the individual plot to be regularised separately after approval of layout framework
- 2) As per this office Order No. 15/2018 dated 12.12.2019 the regularisation of Layout Framework Approved.
- 3) only those unapproved layouts where a part or full number of plots have been sold through a registered sale deed as on 20 th October 2016 shall be Considered for regularization under these rules.
- 4) As per G.O.(Ms).No.172H & UD (UD4 (3) Dept dt. 13.10.2017 OSR charges are exempted for the plots sold on or before 20.10.2016.
- 5) Plots / Sub-division / Layouts shall be regularised under these rules only fir "Residential usage"

LEGEND

- LAYOUT BOUNDARY
- ROAD TO BE HANDED OVER TO THE LOCAL BODY
- PARK TO BE HANDED OVER TO THE LOCAL BODY
- EXISTING ROAD

P.P.D (Regularisation NO : 091
L.O 2017) 2020

APPROVED

VIDE LETTER NO : Reg.L / 23542 / 2018

DATE : 27/02/2020

OFFICE COPY

FOR MEMBER SECRETARY
CHENNAI METROPOLITAN
DEVELOPMENT AUTHORITY

PUZHAL PANCHAYAT UNION

PLAN SHOWING THE ROAD PATTERN AND OSR AREA DETAILS IN S.NO.323/1A & 323/2 AT VILLANGADUPAKKAM VILLAGE AS PER G.O.(Ms).No.78 H & UD UD4 (3) DEPARTMENT DT.04.05.2017 AND G.O. (Ms). No. 172 H & UD(UD4 (3) dept. dated.13.10.2017

(SCALE: 1" = 66' (ALL MEASUREMENTS ARE IN METRE)

